



HB7EV 750V DC 50-400A EV Fuse



Standard/ 标准: GB/T 31465.6, ISO 8820-8, JASO D622

Applicable standards/ 环境可靠性适用的相关标准: GB/T 31465.6, ISO 8820-8, JASO D622, UL 248-20

INTERRUPTING CAPACITY / 分断能力:

50,000 A at 750V DC(50-400A)

TECHNICAL PARAMETERS/ 技术参数:

PART NO. 目录编号	CURRENT RATING 额定电流	SAFETY APPROVALS 安全认证	
		TUV	
HB7EV50	50A	●	●
HB7EV60	60A	●	●
HB7EV70	70A	●	●
HB7EV80	80A	●	●
HB7EV90	90A	●	●
HB7EV100	100A	●	●
HB7EV125	125A	●	●
HB7EV150	150A	●	●
HB7EV175	175A	●	●
HB7EV200	200A	●	●
HB7EV225	225A	●	●
HB7EV250	250A	●	●
HB7EV275	275A	●	●
HB7EV300	300A	●	●
HB7EV325	325A	●	●
HB7EV350	350A	●	●
HB7EV400	400A	●	●

● DENOTES FOR APPROVAL

○ DENOTES FOR PENDING

● 表示已取得安全认证

○ 表示正在申请安全认证

Dimensions/ 尺寸:

Unit 单位: mm

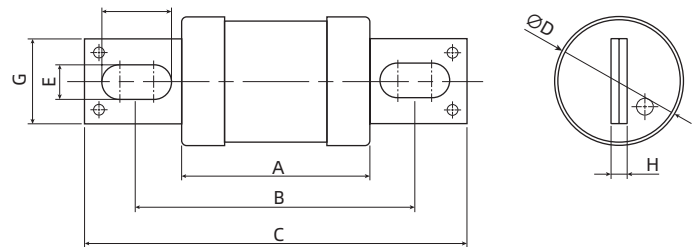

额定电流 Current Rating	尺寸 Dimensions(mm)							
	A	B	C	D	E	F	G	H
50-250A	54	73	92	31	8.2	10.2	20	4
275-400A	54	80	110	38	10.4	19.9	25	4

HB7EV 系列 平均 I-T 曲线图 (仅供参考)

AVERAGE I-T CHARACTERISTICS CURVE
(FOR REFERENCE ONLY)

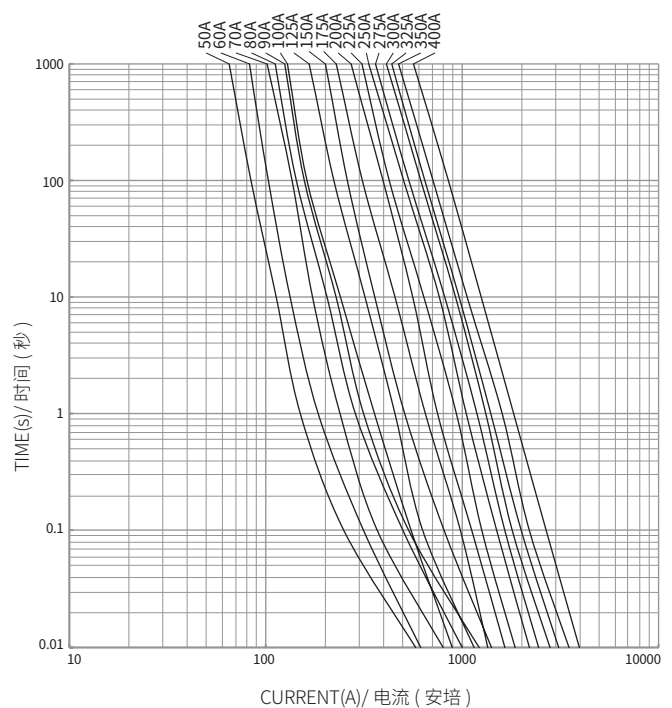

测试电流 Test Current(A)	熔断时间 /Fusing Time (s)			
	$I_R < 60A$		$I_R \geq 60A$	
	min.	max.	min.	max.
$1.1 I_R$	14400	-----	14400	-----
$1.35 I_R$	150	3600	150	3600
$1.5 I_R$	10	1000	20	1500
$2 I_R$	0.5	100	1	300
$3 I_R$	0.1	15	0.2	30
$5 I_R$	0.05	1.0	0.05	1.0